





Stylish Presentation with No Onward Chain! This two bedroom conversion apartment is ideally located on North Parade, Whitley Bay. Leading on to Promenade, North Parade provides excellent access to all Whitley Bay has to offer, with countless shops, bars and also its cafe culture along with transport links via Whitley Bay Metro Station providing access to Tynemouth and on to Newcastle City Centre.

With spot lighting throughout, the accommodation briefly comprises: open plan living space with walk in bay, kitchen area with a range of fitted units and work surfaces; hallway with storage cupboard; shower room complete with three piece suite and spot lighting; two bedrooms, bedroom one with feature free standing bath and French doors leading out to the rear yard. Externally, an enclosed yard with fenced boundaries. With no onward chain, early viewings are advised.

Conversion Apartment | Two Bedrooms | Open Plan Living Space & Kitchen Area | Shower Room | Rear Yard | Stylish Presentation | No Onward Chain | Leasehold: 106 Years Remaining | Service Charge: £1920 PA | Council Tax Band A | EPC: C

EPC: C

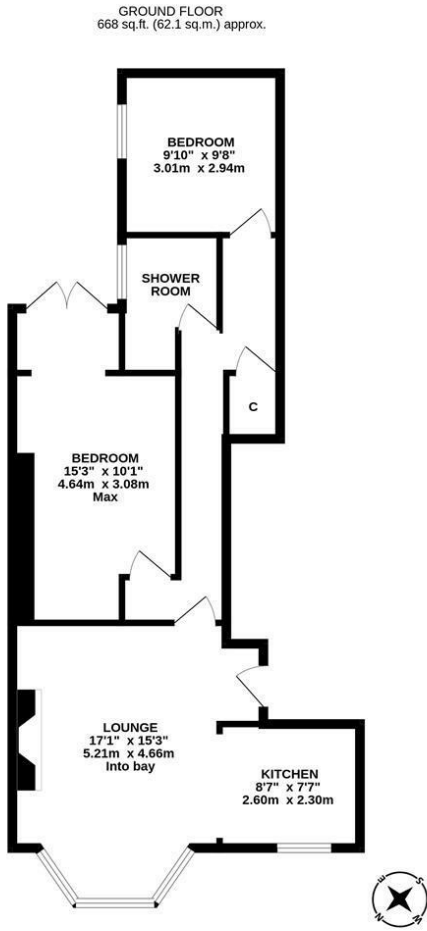

Offers Over £145,000

**IMPORTANT NOTE:** These particulars and the descriptions and measurements herein do not constitute representation and whilst every effort has been made to ensure accuracy, this cannot be guaranteed.

